

# Innovative Door-Fender Single™

## Assembly Instructions

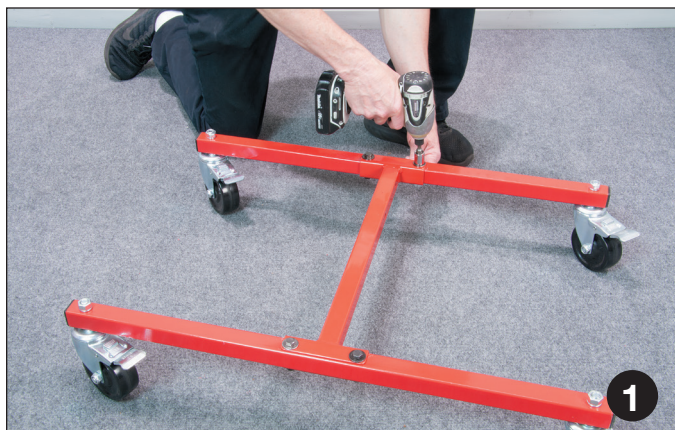

After wheels are mounted to base legs, bolt base cross support using 9/16" bolts, nuts and washers.



Next, install base upright using using 9/16" bolts, nuts and washers. Tighten all bolts firmly.



Insert supports as shown.

# Innovative Door-Fender Single™

## P/N I-DFS

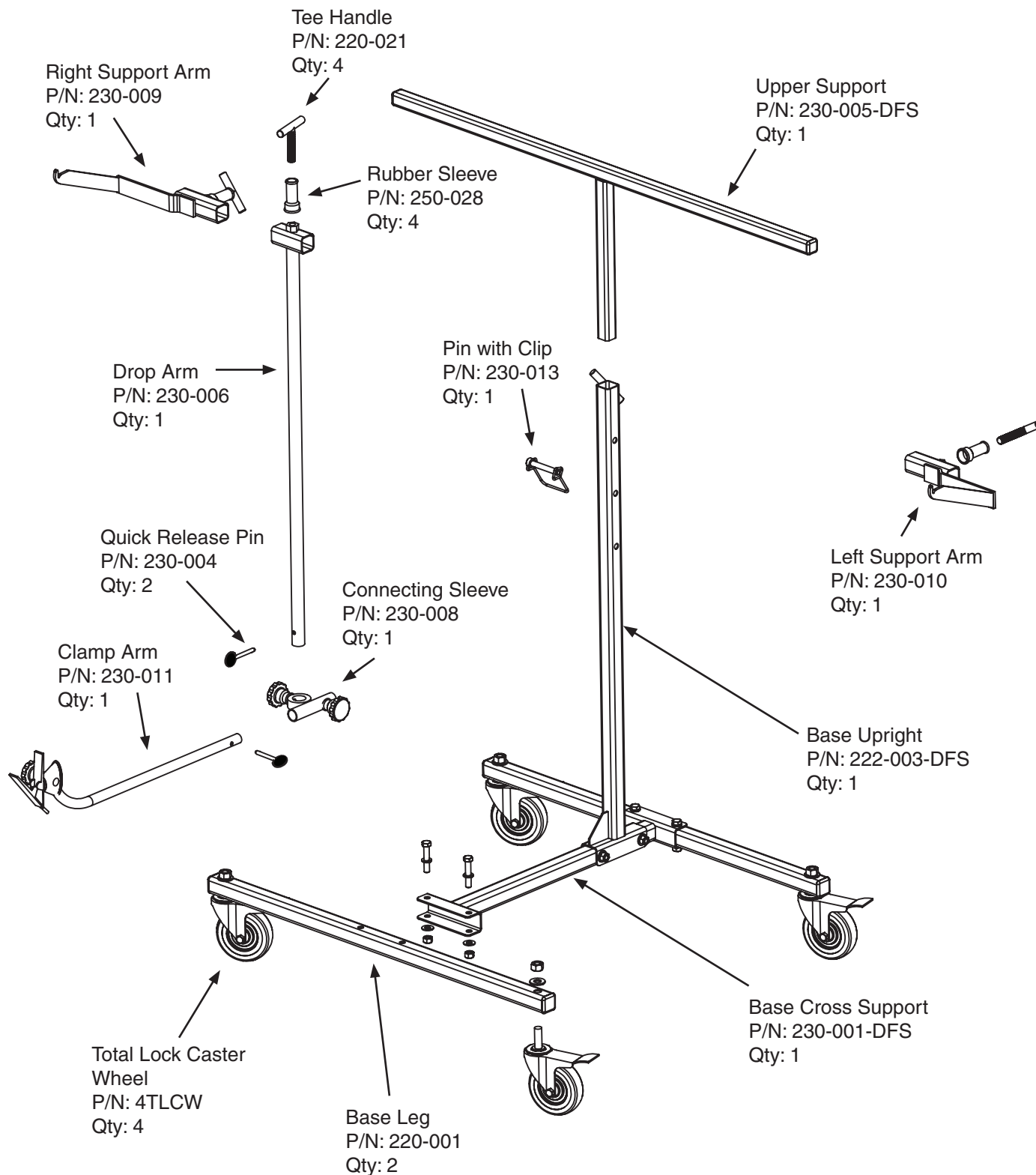

If you have any comments, questions or concerns about our products or are missing a part, please contact us at 1-866-438-4884 or 651-415-0733.