

Innovative Wall SuperStorage™

Assembly Instructions



1
Locate 16" studs on center. All crossbar holes must hit studs in wall. This step not required on masonry walls.



2
Set top crossbar at desired top shelf height. Level crossbar and mark holes 16" on center.



3
Using a 9/32" bit, drill pilot holes for top crossbar. For masonry walls, pre-drill using 1/4" masonry bit followed by 5/8" masonry bit. Insert lead anchor.

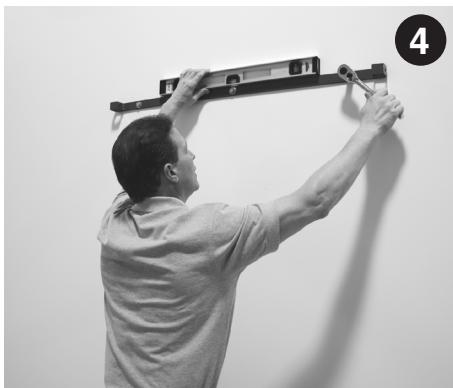

4
Tighten lag bolts with 9/16" socket wrench. Confirm leveling before final tightening.



5
Insert side rails. Do not tighten bolts yet.

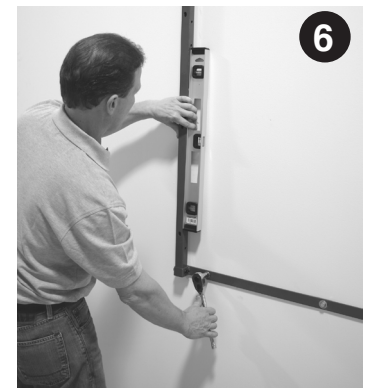

6
Bolt lower crossbar to side rails. Plumb side rails, mark holes. Pre-drill using 9/32" bit. Tighten lower crossbar bolts.



7
Tighten side rail bolts using 9/16" socket and 9/16" end wrench.

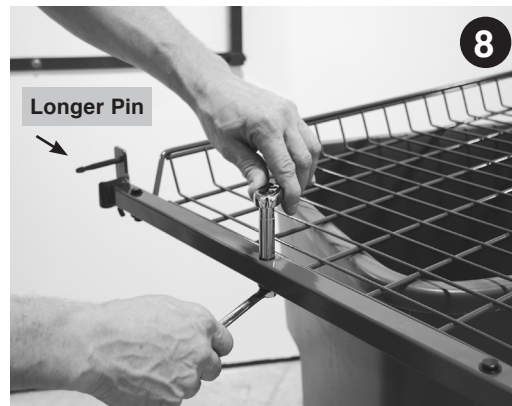

8
Mount side rail supports on top of wire basket using 7/16" socket and wrench. Note longer pin is on the left side as shown.

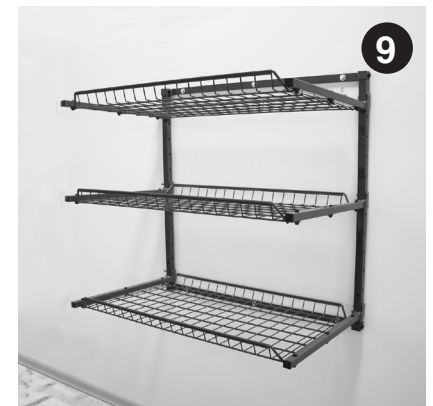

9
Set shelves at desired heights.

Innovative Wall SuperStorage™

